



TRAVELER
GUITAR

User Guide

THANK YOU FOR PURCHASING A TRAVELER ACOUSTIC TB-4P!

Traveler Guitar is the industry's leading manufacturer of full-scale, travel-sized instruments. Most travel guitars sacrifice playability for portability—but at Traveler Guitar, we believe players need both. Since 1992, we have designed full-scale acoustic and electric travel guitars, offering a wide variety of solutions for players on-the-go.

The Traveler Guitar TB-4P Bass you hold in your hands represents a revolution in travel bass guitar design—an electric bass guitar that can be played anywhere. Its unique design makes it compact for travel and small enough to fit in an airline overhead compartment.

Join the community on our Photo Lounge by sending us images of you and your Traveler Guitar in exotic locations, or follow us on Facebook for more up-to-date info.

UNPACKING YOUR GUITAR

If your guitar is factory packed it may be wrapped in a thin, temperature insulating bag. This bag can be discarded.

INCLUDED ACCESSORIES

Gig-Bag, small allen wrench for knobs, and truss rod wrench



travelerguitar.com

CONSTRUCTION & SETUP

CONSTRUCTION:

The TB-4P bass comes equipped with a Seymour Duncan Designed Mustang Bass MM-101 pickup and a built-in Traveler Guitar bass headphone amplifier. This headphone amplifier allows you to plug headphones directly into the bass guitar without needing external equipment and it allows you to plug external audio devices into it to mix the signal with the instrument output.

The in-body tuning system uses standard tuning machines mounted in the bass guitar's body to facilitate the use of standard guitar strings. The bass has many standard features such as an adjustable truss rod, an adjustable bridge, volume and tone controls and a standard 1/4" output.

SETUP:

Your new Traveler Guitar TB-4P will arrive ready to play.

STRING ROLLERS

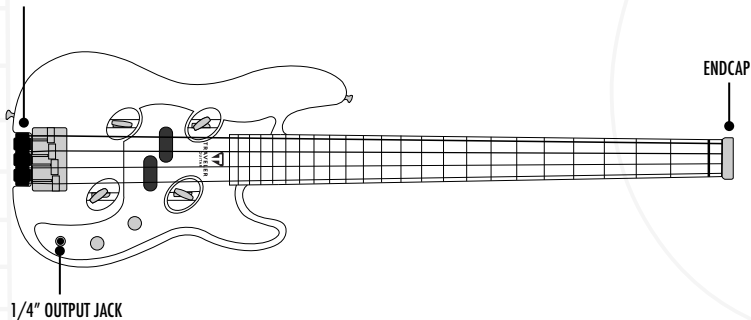

ON-BOARD ELECTRONICS

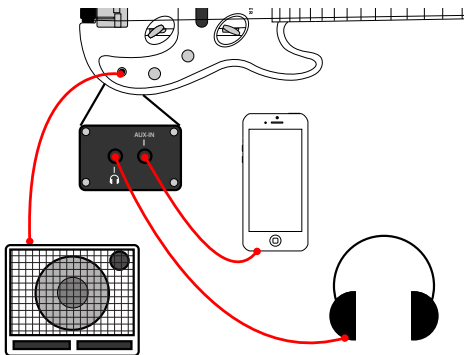

USING THE ELECTRONICS:

The TB-4P features a Seymour Duncan designed Mustang Bass style MM-101 pickup and Volume and tone knobs. A standard 1/4" output jack can be used to plug the bass into an amplifier of your choice. The built-in headphone amp powers headphones from the 1/8" output on the jackplate. To activate the headphone amp, plug into the headphone jack. The headphone signal is affected by the Volume and Tone knobs. Be sure to unplug all cables from your guitar when not in use to save battery life.

USING THE AUX-IN:

The TB-4P's electronics allow you to mix an auxiliary signal with the bass signal and the mixed signal will come through the headphones and 1/4" outputs. Plug your mobile device into the 1/8" aux-in jack on the jackplate and adjust the volume on your device to the desired level.

CHANGING THE BATTERY:

The "BATT LO" indicator will light it's time to replace the batteries. The battery compartment is located on the back of the guitar. 2 AAA batteries are required.

STRINGING AND TUNING STREAMLINE SYSTEMS

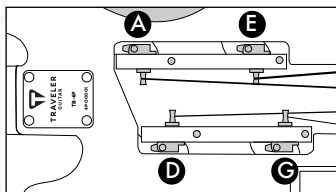

Rear

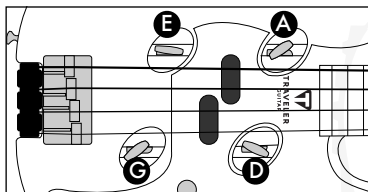

Front

INSTALLING STRINGS:

The TB-4P uses standard, ball-end bass strings. (Factory installed D'Addario EXL-165.) No special tools are required for string changes.

The In-Body™ tuners on your Traveler Guitar operate just like the tuners on a standard guitar. We recommend changing the strings two at a time. Removing all the strings at once may cause some of the components that are held in place by string tension to come loose. First remove the old E, and A strings, and then install the new strings in their places. Repeat this process on the D and G strings.

To change strings, thread the string through the correct hole in the endcap and wrap the string around the string roller to the proper tuning machine hole. Leave approximately 2 ½ inches of slack in the string to allow 3 to 4 wraps on the tuner. Bend the string to anchor it in place in order to hold the string after it is fed through the tuner. Over-wrapping or under-wrapping the string around the tuning machine post may cause tuning problems.

TUNING:

Hold the guitar in playing position and tune the strings as normal. Tuning the tuning machine in a clockwise motion raises the pitch.

CLEANING, STORAGE, AND GENERAL CARE

CLEANING:

Periodic cleaning and polishing will help protect your Traveler Guitar. Use a polish formulated for musical instruments and apply it according to the polish directions—or, you can wipe the guitar down with a clean, damp cloth followed quickly by a clean, dry cloth. To clean residue off the fingerboard, you can use extra-fine steel wool to rub up and down the length of the fingerboard over the top of the frets. Never use furniture polish on the guitar, as you may damage the finish.

STORAGE:

When not in use, your Traveler Guitar should be stored in its included gig bag to protect it from exposure to the elements. Protect your guitar from extreme temperatures and changes in humidity. Never leave your Traveler Guitar in a closed vehicle or any other location where the guitar will be exposed to extreme heat. If you live in a dry climate, you may want to use a guitar humidifier.

ADJUSTMENTS:

We recommend leaving complicated operations (such as truss rod adjustments) to a trained guitar technician. Improper truss rod adjustments may damage your guitar and void your warranty.

HANG STRAP:

The leather hang strap attached to your guitar's endcap was designed to aid in-store display, but it can also be used to hang your guitar from a wall mount or stand. Be sure your guitar is secure before walking away from it. If you wish, you can remove the strap by clipping the plastic tie with wire cutters. Be careful not to scratch the finish on the neck or endcap.

"BUMPER TO BUMPER" LIMITED LIFETIME WARRANTY

Each Traveler Guitar instrument is warranted to be free from defects in materials and workmanship for as long as it is owned by the original retail purchaser except strings, tuning machines, frets, switches, electronic components, jacks, pickguards, and plated surfaces, which are warranted for a period of three (3) years from the date of the original purchase. The warranty is only eligible to the original owner, and the guitar must have been purchased from an authorized Traveler Guitar dealer.

Traveler Guitar will replace or repair, at its discretion, any Traveler Guitar instrument or part thereof, which is found by Traveler Guitar to be defective. Traveler Guitar reserves the right to use original replacement materials or materials of similar design at the time of the repair.

To become eligible for warranty service, the original purchaser must:

1. Submit a completed warranty card or [online registration](#) form to Traveler Guitar.
2. Contact Traveler Guitar to obtain a Return Authorization Code before returning any instrument for service.
3. Provide proof of purchase with all requests for warranty service (original receipt.)
4. Be responsible for all freight and transportation to and from Traveler Guitar's facility in Redlands, CA.

The Traveler Guitar Warranty does not cover:

1. Instruments that have been altered or modified in any way, including altered or removed serial numbers.
2. Instruments that have been subjected to extreme temperature or humidity, chemicals, synthetic materials or other abnormal conditions.
3. Wear, discoloration or marks on the finish, metal plating or wood grain of the guitar.
4. Setups, adjustments, tonal characteristics or routine maintenance of any kind.
5. Instruments that have been damaged due to misuse or neglect.
6. Normal wear and tear to hardware including: strings, tuning machines, frets, switches, electronic components, jacks, pickguards, and plated surfaces.

Please contact us first to resolve any warranty issues.

Warranty Questions:

Traveler Guitar ATTN: Warranty Information
440 Business Center Court
Redlands, CA 92373 USA
travel@travelerguitar.com