

Ratio Tune-A-Leles Installation Manual

Step 1

Remove your old machine heads, screws, and bushings

Step 2

Check the peg-head holes to determine if any modification is needed to accommodate the press-fit bushings provided

(use reamer to widen holes if needed)

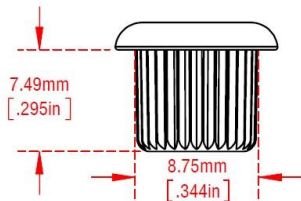

Step 3

Press in the new bushings

Step 4

Mount tuners & align with headstock

(using a straight-edge if applicable)

Step 5

Use fine tip marker or center punch to mark screw location

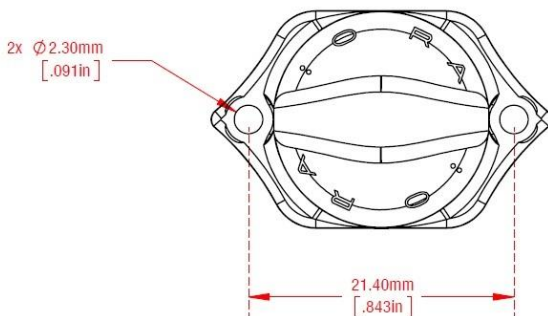

Step 6

Remove tuner and drill small pilot hole in marked locations

Step 7

Reinstall tuners with supplied screws